



Built-in AI Code Reader SR-X Series Instruction manual

Details on each function are available for download from the following web site.
各機能の詳細は以下の Web サイトからダウンロードできます。

www.keyence.com/support_sr-x



Introduction

Read this instruction manual before using the product in order to achieve maximum performance.
Keep this instruction manual in a safe place after reading it so that it can be used at any time.
For details, refer to the user's manual.

■ Symbols

The following symbols alert you to important messages. Be sure to read these messages carefully.

	Indicates a hazardous situation which, if not avoided, will result in death or serious injury.
	Indicates a hazardous situation which, if not avoided, could result in death or serious injury.
	Indicates a hazardous situation which, if not avoided, could result in minor or moderate injury.
	Indicates a situation which, if not avoided, could result in product damage as well as property damage.

Safety Information for SR-X Series

■ General Precautions

	<ul style="list-style-type: none"> Do not use this product for the purpose to protect a human body or a part of human body. Do not use this product in a hazardous location and/or potentially explosive atmosphere. Do not use this product in an application that may cause death, serious injury or serious property damage due to a failure with this product should occur, such as nuclear power plants, on aircraft, trains, ships, or vehicles, used within medical equipment, playground equipment, roller coasters and other rides, etc.
	<ul style="list-style-type: none"> If the equipment is used in a manner not specified by the manufacturer, the protection provided by the equipment may be impaired. You must perform a sufficient risk assessment for the machine where this product is to be installed prior to installing this product. Provide appropriate protective fail-safe measures on the machine independent from this product in case a failure with this product should occur.
	<ul style="list-style-type: none"> You must verify that the SR-X Series are operating correctly in terms of functionality and performance before the start and the operation of the SR-X Series.
	<ul style="list-style-type: none"> KEYENCE never warrants the function or performance of the SR-X Series if it is used in a manner that differs from the SR-X Series specifications contained in this instruction manual or if the SR-X Series are modified by yourself. When the SR-X Series is used in combination with other instruments, functions and performance may be degraded, depending on operating conditions and the surrounding environment.

Precautions on Proper Use

	<ul style="list-style-type: none"> Do not use a voltage other than that described in the specifications with the SR-X Series. Doing so may cause damage to the unit. Be sure to turn off the power to devices attached to the SR-X Series when you plug in or unplug the cables. Failure to do so may cause damage to the SR-X Series. Do not disassemble or modify the SR-X Series. Doing so may cause damage to the unit. Place cables as far away as possible from high-voltage lines and power lines. Otherwise, electrical noise can be generated that may cause a product failure or malfunction. The SR-X Series is a precision instrument. Do not impact or drop the instrument. Pay particular attention when transporting or installing the unit. Do not carry the SR-X Series by holding its cables. This may cause cable breaks or damage to the unit due to the impact of bumping each other. Do not allow water, oil, dust, or other foreign substances to stick to the scanner. This may cause read errors. Use a soft, dry cloth or a soft cloth dipped in alcohol to wipe any substance from the scanner. Do not turn off the power of the SR-X Series while accessing files. The internal data may be corrupted.
--	--

Precautions on Regulations and Standards

■ CE and UKCA Markings

Keyence Corporation has confirmed that this product complies with the essential requirements of the applicable EU Directive(s) and UK regulations, based on the following specifications. Be sure to consider the following specifications when using this product in the Member States of European Union and in the United Kingdom.

● EMC Directive (CE) and Electromagnetic Compatibility Regulations (UKCA)

- Applicable standards (BS) EN61326-1, Class A (BS) EN61326-1

- The length of cable connected to the power supply connector must be less than or equal to 30 m.
- Wrap the USB cable around a ferrite core close to the device to connect to. Ferrite core: TDK ZCAT1730-0730A-BK equivalent
- This product is intended to be used in an industrial electromagnetic environment.

Remarks: These specifications do not give any guarantee that the end-product with this product incorporated complies with the essential requirements of EMC Directive and Electromagnetic Compatibility Regulations. The manufacturer of the end-product is solely responsible for the compliance on the end-product itself according to EMC Directive and Electromagnetic Compatibility Regulations.

■ UL Certificate

This product is a UL/c-UL certified product.

- UL File No.: E222809
 - Category: QUYY,QUYYX7
- Be sure to consider the following specifications when using this product as an UL/c-UL Listed product.
- Overvoltage category I
 - Use this product under pollution degree 3.
 - Use this product at the altitude of 2500 m or less.
 - Indoor use only.
 - Ensure the external circuits to be connected to the SR-X Series are SELV circuits.
 - CSA or UL certified power supply that provides Class 2 output as defined in the CEC (Canadian Electrical Code) and NEC (National Electrical Code).
 - Only USB memory or designated devices* can be connected to the USB port.

■ KC mark (Republic of Korea)

사용자안내문

이 기기는 업무용 환경에서 사용할 목적으로 적합성평가를 받은 기기로서 가정용 환경에서 사용하 는 경우 전파간섭의 우려가 있습니다.

■ North American Regulations

This product complies with the following North American regulations.

- Applicable regulation FCC Part15 Subpart B, Class A Digital Device ICES-003, Class A Digital Apparatus

- Operation is subject to the following two conditions: (1) This device may not cause harmful interference, and (2) this device must accept any interference received, including interference that may cause undesired operation.
- FCC CAUTION
Changes or modifications not expressly approved by the party responsible for compliance could void the user's authority to operate the equipment.

■ 台灣 BSMI 認證

● 國家標準 CNS13438

警告: 為避免電磁干擾, 本產品不應安裝或使用於住宅環境。
警告使用者: 此為甲類資訊技術設備, 於居住環境中使用時, 可能會造成射頻擾動。在此種情況下, 使用者會被要求採取某些適當的對策。
• 請務必將 SR-X 系列的金屬外殼接地。
• 請務必將控制纜線的 SGND 電線接地。

● 國家標準 CNS15663

國家標準 CNS15663(*) 中規定之「限用物質含有情況」標示聲明如下。
(*)CNS15663: 電機電子類設備降低限用化學物質含量指引

設備名稱	一維 / 二維條碼讀取器				
	型號 (形式)				
	SR-X100, SR-X100W, SR-X300, SR-X300W				
單元	限用物質及其化學符號				
	鉛 (Pb)	汞 (Hg)	鎘 (Cd)	六價鉻 (Cr ⁶⁺)	多溴聯苯 (PDD) (PBDE)
電路板	—	○	○	○	○
外殼	○	○	○	○	○
LED 模組	—	○	○	○	○
內部用線	—	○	○	○	○

備考 1. "○" 係指該項限用物質之百分比含量未超出百分比含量基準值。

備考 2. "—" 係指該項限用物質為排除項目。

● 聯繫地址

進口廠商: 台灣基恩斯股份有限公司
進口商地址: 104 台北市中山區中山北路二段 42 號 12 樓
進口商電話: +886-2-2721-8080

Safety Precautions on LED Product

The degree of risk of this product is shown below.

Light source	Risk Group*
Aimer LED (Green)	Risk Group 1
Lighting LED (Red)	Risk Group 1
Lighting LED (White) * only for SR-X300/X300W	Risk Group 1

* LED/Lamp product is classified as shown below according to IEC 62471.

- Exempt Group
Does not pose any photobiological hazard
- Risk Group 1 (Low-Risk)
Does not pose a hazard due to normal behavioral limitations on exposure.
- Risk Group 2 (Moderate-Risk)
Does not pose a hazard due to the aversion response to very bright light sources or due to thermal discomfort.
- Risk Group 3 (High-Risk)
May pose a hazard even for momentary or brief exposure.

Package Contents

Model	Name	Package content	Qty.	Appearance
SR-X300/X300W SR-X100/X100W	Built-in AI Code Reader	Reader unit	1	
		Instruction manual	1	
		Ethernet port cover	1	

Part Names and Functions

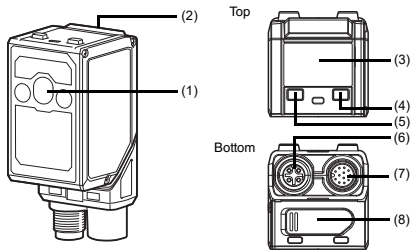

No.	Name	Description
(1)	Scanner	Section that reads codes.
(2)	Status indicating LED	Indicates whether the reading has succeeded or failed, setup software connection status, etc.
(3)	Display ¹	Shows reading results or reading data.
(4)	ENTER button ²	Button used to confirm functions.
(5)	SELECT button ¹	Button used to select functions.
(6)	Ethernet port	Port for connecting the Ethernet cable.
(7)	Control port	Port for connecting the control cable.
(8)	USB port	Port for connecting the USB memory ³ or designated devices ⁴ .

*1 Only SR-X300/X300W is equipped

*2 [TRG] button in SR-X100/X100

*3 Only SR-X100/X100W is equipped

*4 OP-88569

Startup Procedure

Step 1

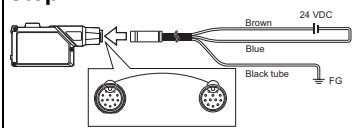

Step 2

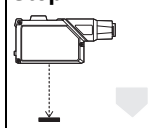

Connection and Wiring

■ Connecting the control cable and wiring

Wire color	Name	Description	Signal direction	Initial assignment
Brown	24 V	24 VDC	Input	-
Blue	0 V	Power GND	-	-
Orange	RXD (RD)	RS-232C Receive	Input	-
Yellow	TXD (SD)	RS-232C Send	Output	-
Purple	SGND	RS-232C GND	-	-
Green	IN1	Input signal 1	Input	Reading start
Gray	IN2	Input signal 2	Input	-
White and blue	IN COM	Input common	-	-
Pink	OUT1	Output signal 1	Output	Reading OK
Light blue	OUT2	Output signal 2	Output	Reading ERROR
White	OUT3	Output signal 3	Output	BUSY
Black	OUT COM	Output common	-	-
Black tube	FG	Frame ground	-	-

NOTICE	<ul style="list-style-type: none"> Be sure to turn power off before attempting to connect or disconnect the control cable. Insert the connector straight so that it is not tilted and then tighten it securely. Under-tightening can lead to a loose connector due to vibrations, resulting in poor contact. * Screw tightening torque: 0.4 to 0.6 N·m Insulate unused wires individually. Be sure to provide Class D ground for the FG wire. The shield and FG wires of the control cable and the shield wire of the Ethernet cable are electrically connected via the main unit housing. Be sure to provide them with a common ground.
---------------	--

■ Connecting the Ethernet cable

NOTICE	<ul style="list-style-type: none"> When connecting the connector, insert it so that it does not tilt, and then push in and tighten the connector securely. Under-tightening can lead to a loose connector due to vibrations, resulting in poor contact. * Screw tightening torque: 0.8 to 1.0 N·m Do not bend the base of the Ethernet cable connector repeatedly. It may cause connection failure.
---------------	--

Mounting

● For direct mounting

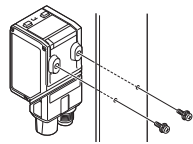

● When using OP-88696

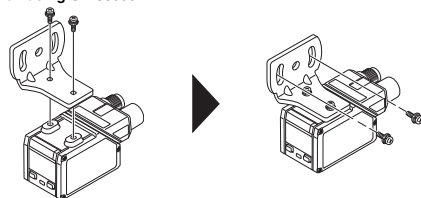

● When using OP-88697

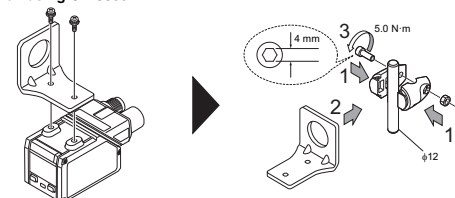

● When using OP-88698

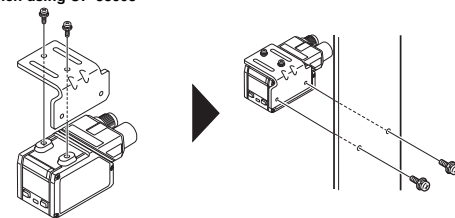

● When using OP-88699

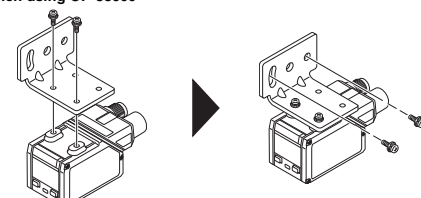

■ Mounting screw

	For mounting the SR-X Series	Tightening torque	For optional mounting bracket
For direct mounting	M3×2 ^{*1}	0.4N·m	-
When using OP-88696			M5×2 ^{*2}
When using OP-88697			-
When using OP-88698	M3×2 (package)	0.4N·m	M3×2 ^{*3}
When using OP-88699			M5×2 ^{*2}

*1 Mounting screws are not included. Screw hole depth of the SR-X Series: 3.5 mm
 *2 Mounting screws are not included.

*3 Mounting screws are not included. Screw hole depth of the OP-88698: 3 mm

■ Cable bending R

	Control cable	Ethernet cable
Stationary	R15mm or more	R15mm or more
Moving	R20mm or more	R50mm or more

When Using Optional Attachments

Attachments (SR-XESD/XLP/XHR) that can be attached to the SR-X Series are available as options. For details about mounting the attachment to the SR-X Series, see the SR-X Series User's Manual.

Specifications

Model		SR-X300	SR-X300W	SR-X300 + SR-XHR	SR-X100	SR-X100W	
Type		Standard type (2.3 megapixels)	Wide range type (2.3 megapixels)	High resolution type	Standard type (1.4 megapixels)	Wide range type (1.4 megapixels)	
Receiver	Sensor	CMOS Image Sensor					
	Number of pixels	1920 x 1200			1360 x 1024		
	Focus adjustment	Automatic*1					
Light emitter	Light source	High-intensity red LED/White LED			High-intensity red LED		
	Pointer light source	High-intensity green LED					
Reading specifications	Supported symbol	QR, MicroQR, DataMatrix(ECC200), DMRE, GS1 DataMatrix, PDF417, MicroPDF417, GS1 Composite(CC-A/CC-B/CC-C), DotCode, MaxiCode, Aztec Code					
		Barcode CODE39, ITF, 2of5(Industrial 2of5), COOP 2of5, NW-7(Codabar), CODE128, GS1-128, GS1 DataBar, CODE39, JAN/EAN/UJC, Trioptic CODE39, CODE39 Full ASCII, Pharmacode, Postal(Japan Postal, IMB)					
	Minimum resolution	Barcode	0.024 mm	0.060 mm	0.010 mm	0.024 mm	0.060 mm
		2D code	0.082 mm	0.082 mm	0.082 mm	0.082 mm	0.082 mm
	Reading distance		70-1000 mm	50-1000 mm	32-47 mm	70-1000 mm	50-1000 mm
Reading view range		104 mm x 65 mm (Distance: 300 mm)	267 mm x 166 mm (Distance: 300 mm)	12.3 mm x 7.7 mm (Distance: 47 mm)	74 mm x 55 mm (Distance: 300 mm)	189 mm x 142 mm (Distance: 300 mm)	
Control input	Points	2					
		Input type Bidirectional voltage input					
	Maximum rating	30 VDC					
	Minimum ON voltage	15 VDC					
	Maximum OFF current	0.2 mA					
Control output	Points	3					
		Output type Photo MOS relay output					
	Maximum rating	30 VDC					
	Maximum load current	1 output: 50 mA or less, 3-output total: 100 mA or less					
	Leakage current when OFF	0.1 mA or less					
Residual voltage when ON	1 V or less						
Ethernet	Communication standard	IEEE 802.3 compliant, 100BASE-TX					
	Supported protocol	TCP/IP, SNMP, FTP, SFTP, HTTP, HTTPS, BOOTP, EtherNet/IP™, PROFINET, KV STUDIO, MC Protocol, OMRON PLC Link					
		RS-232C compliant					
Serial communication	Communication speed	600, 1200, 2400, 4800, 9600, 19200, 38400, 57600, 115200 bps					
	Supported protocol	None, KV STUDIO, MC Protocol, SYSWAY					
USB	Communication standard	USB 2.0 High Speed compliant					
Environmental resistance	Enclosure rating	IP65 / IP67 (IEC60529) ^{*2, *3}					
	Operating ambient temperature / Storage ambient temperature	0 to +45°C / -10 to +50°C					
	Operating ambient humidity / Storage ambient humidity	Max. 85%RH (No condensation)					
Rating	Power supply voltage	24 VDC±25%/±20%				Approx. 650 mA	
	Current consumption	Approx. 750 mA				Approx. 180 g	
Weight		Approx. 200 g		Approx. 225 g	Approx. 180 g		

*1 The focus position can be automatically adjusted during installation and during tuning.

*2 Attach a USB port cover to meet the protective structural specification.

*3 IP rating was not tested by UL
 Number of system ROM-rewrite times: 100,000 times

WARRANTIES AND DISCLAIMERS

- KEYENCE warrants the Products to be free of defects in materials and workmanship for a period of one (1) year from the date of shipment. If any models or samples were shown to Buyer, such models or samples were used merely to illustrate the general type and quality of the Products and not to represent that the Products would necessarily conform to said models or samples. Any Products found to be defective must be shipped to KEYENCE with all shipping costs paid by Buyer or offered to KEYENCE for inspection and examination. Upon examination by KEYENCE, KEYENCE, at its sole option, will refund the purchase price of, or repair or replace at no charge any Products found to be defective. This warranty does not apply to any defects resulting from any action of Buyer, including but not limited to improper installation, improper interfacing, improper repair, unauthorized modification, misapplication and mishandling, such as exposure to excessive current, heat, coldness, moisture, vibration or outdoors air. Components which wear are not warranted.
- KEYENCE is pleased to offer suggestions on the use of its various Products. They are only suggestions, and it is Buyer's responsibility to ascertain the fitness of the Products for Buyer's intended use. KEYENCE will not be responsible for any damages that may result from the use of the Products.
- The Products and any samples ("Products/Samples") supplied to Buyer are not to be used internally in humans, for human transportation, as safety devices or fail-safe systems, unless their written specifications state otherwise. Should any Products/Samples be used in such a manner or misused in any way, KEYENCE assumes no responsibility, and additionally Buyer will indemnify KEYENCE and hold KEYENCE harmless from any liability or damage whatsoever arising out of any misuse of the Products/Samples.

(4) OTHER THAN AS STATED HEREIN, THE PRODUCTS/SAMPLES ARE PROVIDED WITH NO OTHER WARRANTIES WHATSOEVER. ALL EXPRESS, IMPLIED, AND STATUTORY WARRANTIES, INCLUDING, WITHOUT LIMITATION, THE WARRANTIES OF MERCHANTABILITY, FITNESS FOR A PARTICULAR PURPOSE, AND NON-INFRINGEMENT OF PROPRIETARY RIGHTS, ARE EXPRESSLY DISCLAIMED.

IN NO EVENT SHALL KEYENCE AND ITS AFFILIATED ENTITIES BE LIABLE TO ANY PERSON OR ENTITY FOR ANY DIRECT, INDIRECT, INCIDENTAL, PUNITIVE, SPECIAL OR CONSEQUENTIAL DAMAGES (INCLUDING, WITHOUT LIMITATION, ANY DAMAGES RESULTING FROM LOSS OF USE, BUSINESS INTERRUPTION, LOSS OF INFORMATION, LOSS OR INACCURACY OF DATA, LOSS OF PROFITS, LOSS OF SAVINGS, THE COST OF PROCUREMENT OF SUBSTITUTED GOODS, SERVICES OR TECHNOLOGIES, OR FOR ANY MATTER ARISING OUT OF OR IN CONNECTION WITH THE USE OR INABILITY TO USE THE PRODUCTS, EVEN IF KEYENCE OR ONE OF ITS AFFILIATED ENTITIES WAS ADVISED OF A POSSIBLE THIRD PARTY'S CLAIM FOR DAMAGES OR ANY OTHER CLAIM AGAINST BUYER. In some jurisdictions, some of the foregoing warranty disclaimers or damage limitations may not apply.

BUYER'S TRANSFER OBLIGATIONS:

If the Products/Samples purchased by Buyer are to be resold or delivered to a third party, Buyer must provide such third party with a copy of this document, all specifications, manuals, catalogs, leaflets and written information provided to Buyer pertaining to the Products/Samples.

E 1101-3

Cautions

- Unauthorized reproduction of this manual in whole or part is prohibited.
- The contents of this manual may be changed for improvements without prior notice.
- An utmost effort has been made to ensure the contents of this manual are as complete as possible. If there are any mistakes or questions, please contact a KEYENCE office listed in the back of the manual.
- Regardless of item (3), KEYENCE will not be liable for any effect resulting from the use of this unit.
- Any manuals with missing pages or other paging faults will be replaced.

配置 AI 的条码阅读器 SR-X 系列 使用说明书

各功能的详细信息，可以通过以下网站下载。

www.keyence.com/support_sr-x



前言

为了获得最佳性能，请在本产品之前阅读本使用说明书。请在阅读本使用说明书之后将其保存在安全的地方，以备随时查阅。详情请参阅□□用户手册。

■ 符号

下列符号提醒您注意重要的消息。请务必仔细阅读此类消息。

	表示若不遵则会严重的人身伤害甚至造成人员死亡的危险情况。
	表示若上遵守该注意事项，可能导致人员伤亡。
	表示若不遵则可能会导致轻度或中度人身伤害的危险情况。
	表示若不遵则可能会导致产品损坏及财产损失的情况。

SR-X 系列的安全信息

■ 一般注意事项

	<ul style="list-style-type: none"> 请勿将本产品用于保护人体或人体的任何部分。 不得在防爆区域中使用本产品。 请勿将本产品用于可能会因本产品的运作状态而导致严重人身伤害事故与财产损失用途（发电厂、航空、铁路、船舶、车辆、医疗仪器、游乐设施等）。
	<ul style="list-style-type: none"> 如果未按本公司的规定使用本产品，产品的保护功能可能不会有效地发挥作用。
	<ul style="list-style-type: none"> 设置本产品时，请对装置整体进行风险评估，确认处于适当的低风险状态。请在本产品之外设置适当的保护手段，以便在发生异常时，装置整体可安全运作。
	<ul style="list-style-type: none"> 启动和操作 SR-X 系列之前，必须验证 SR-X 系列在功能和性能方面运转正常。
	<ul style="list-style-type: none"> 对于采用不同于本使用说明书所述 SR-X 系列规格的方式进行操作，或擅自改装 SR-X 系列，KEYENCE 无法保证 SR-X 系列的功能或性能。 将 SR-X 系列与其它设备一起使用时，其功能和性能可能有所下降，具体取决于操作条件和周围环境。

正确使用的注意事项

	<ul style="list-style-type: none"> 请勿使用 SR-X 系列规格书所述之外的电源，否则可能会损坏装置。 剥接电缆时，请务必关闭 SR-X 系列所接设备的电源。否则可能会损坏 SR-X 系列。 请勿拆解或改装 SR-X 系列。否则可能会损坏装置。 请保持电缆远离高压电缆或电源。否则，可能产生电噪声，造成产品故障或失灵。 SR-X 系列为精密仪器。请勿撞击或摔落仪器。运输或安装装置时，请特别小心。 搬运 SR-X 系列时，请勿握持 SR-X 系列所连接的电缆。如果电缆脱落或装置相互碰撞，则会导致装置受损。 请勿让水、灰尘、油或其它异物附着在扫描仪上。否则可能导致读取错误。使用柔软的干布或蘸有酒精的软布来擦拭扫描仪上的任何物质。 请勿在存取文件时关闭 SR-X 系列的电源，否则内部数据可能会损坏。
--	---

LED/ 指示灯产品相关的注意事项

如下所述为本产品的风险组。

光源	风险组 [※]
指示器光源（绿色）	风险组 1
照明光源（红色）	风险组 1
照明光源（白色） 仅 SR-X300/X300W	风险组 1

※ 根据 IEC62471 (JIS C 7550) 对 LED/ 指示灯产品进行如下分类。

- 免除组
不会造成任何光生物学伤害。
- 风险组 1 (低危险度)
不会造成需要对通常行动进行限制的伤害。
- 风险组 2 (中危险度)
不会造成伴随有厌恶感以及过热不舒适的伤害。
- 风险组 3 (高危险度)
即使暂时或短时间曝光也会造成伤害。

包装内容

型号	名称	包装内容	个数	图像
SR-X300/X300W SR-X100/X100W	配置 AI 的条码阅读器	读取器主装置	1	
		使用说明书	1	
		以太网端口盖	1	

部件名称

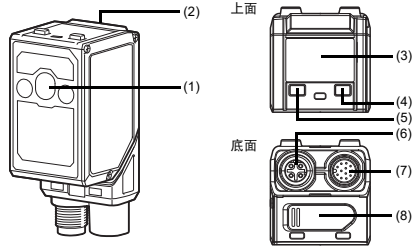

编号	名称	内容
(1)	扫描仪	代码读取部
(2)	状态显示 LED	显示读取是否成功、设置软件连接中状态等
(3)	显示器 ^{※1}	显示读取结果和读取数据
(4)	ENTER 按钮 ^{※2}	决定功能的按钮
(5)	SELECT 按钮 ^{※1}	选择功能的按钮
(6)	以太网端口	连接以太网电缆的端口
(7)	控制端口	连接控制电缆的端口
(8)	USB 端口	连接 USB 盘 ^{※3} 或指定设备 ^{※4} 的端口

- ※1 仅 SR-X300/X300W
- ※2 SR-X100/X100W 时，为 [TRG] 按钮。
- ※3 仅 SR-X100/X100W
- ※4 OP-88569

启动步骤

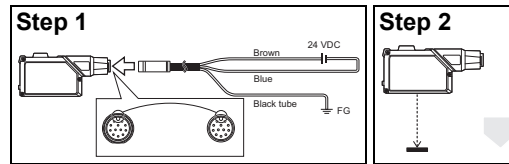

连接和布线

■ 控制电缆的连接和布线

电线颜色	名称	内容	信号方向	初始分配
棕色	24 V	24 V DC	输入	-
蓝色	0 V	电源接地	-	-
橙色	RXD (RD)	RS-232C 接收	输入	-
黄色	TXD (SD)	RS-232C 发送	输出	-
紫色	SGND	RS-232C 接地	-	-
绿色	IN1	输入信号 1	输入	开始读取
灰色	IN2	输入信号 2	输入	-
白色和蓝色斑点	IN COM	输入共通	-	-
粉红色	OUT1 (输出 1)	输出信号 1	输出	读取 OK (合格)
淡蓝色	OUT2 (输出 2)	输出信号 2	输出	读取 ERROR (错误)
白色	OUT3 (输出 3)	输出信号 3	输出	BUSY
黑色	OUT COM	输出共通	-	-
黑 (粗线)	FG	框架接地	-	-

注意

- 试图连接或断开控制电缆之前，请务必关闭电源。
- 连接连接器时，请遵循连接器不倾斜的原则插入并按下连接器，然后拧紧。如果没有拧紧，则震动等原因可能会导致连接器松动，从而可能会出现连接故障。
- 螺丝的紧固扭矩 0.4 至 0.6 N·m
- 请勿对不使用的线进行个别绝缘处理。
- FG 线请务必采用 D 类接地。
- 控制电缆的屏蔽及 FG 线和以太网电缆的屏蔽通过主装置外壳进行电气连接，因此请注意采用共同接地方式。

■ 连接以太网电缆

注意

- 连接连接器时，请遵循连接器不倾斜的原则插入并按下连接器，然后拧紧。如果没有拧紧，则震动等原因可能会导致连接器松动，从而可能会出现连接故障。
- 螺丝的紧固扭矩 0.8 至 1.0 N·m
- 请勿反复弯曲以太网电缆连接器的根部。否则可能会导致连接故障。

主体的安装方法

● 直接安装时

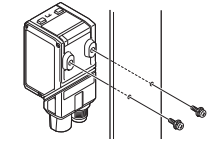

● 使用 OP-88696 时

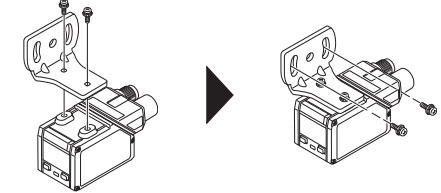

● 使用 OP-88697 时

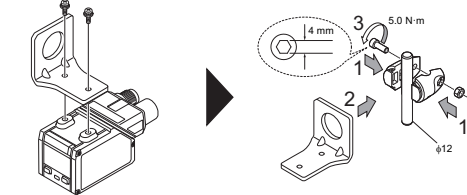

● 使用 OP-88698 时

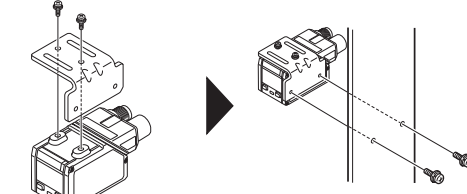

● 使用 OP-88699 时

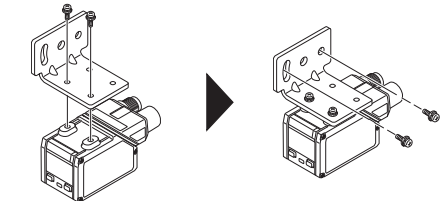

■ 安装用螺丝

	主体安装用	紧固力矩	支架安装用
直接安装时	M3×2 ^{※1}	0.4N·m	-
使用 OP-88696 时	M3×2 (包括)	0.4N·m	M5×2 ^{※2}
使用 OP-88697 时			-
使用 OP-88698 时			M3×2 ^{※3}
使用 OP-88699 时			M5×2 ^{※2}

※1 请另行准备。主体安装用螺孔的深度: 3.5 mm

※2 请另行准备。

※3 请另行准备。OP-88698 的螺丝孔深度: 3 mm

■ 电缆弯曲半径

	控制电缆	Ethernet 电缆
不移动时	大于等于 R15 mm	大于等于 R15 mm
移动时	大于等于 R20 mm	大于等于 R50 mm

主体配件的安装方法

作为选项，本产品备有可安装到主体上的配件 (SR-XESD/XLP/XHR)，有关各安装方法，请确认 SR-X 系列用户手册。

规格							
型号		SR-X300	SR-X300W	SR-X300 + SR-XHR	SR-X100	SR-X100W	
类型		标准型 (230 万像素)	广视野型 (230 万像素)	高分辨率型	标准型 (140 万像素)	广视野型 (140 万像素)	
接收器	传感器	CMOS 图像传感器					
	像素数	1920 x 1200			1360 x 1024		
	对焦调整	自动※1					
发光部	照明光源	高亮度红色 LED/ 白色 LED			高亮度红色 LED		
	指示器光源	高亮度绿色 LED					
读取规格	支持的符号	QR、MicroQR、DataMatrix (ECC200)、DMRE、GS1 DataMatrix、PDF417、MicroPDF417、GS1 Composite (CC-A/CC-B/CC-C)、DotCode、MaxiCode、Aztec Code					
		条码	CODE39、ITF、2of5 (Industrial 2of5)、COOP 2of5、NW-7 (Codabar)、CODE128、GS1-128、GS1 DataBar、CODE93、JAN/EAN/UPC、Trioptic CODE39、CODE39 Full ASCII、Pharmacode、Posta (Japan Postal、IMB)				
	最小分辨率	二维条码	0.024 mm	0.060 mm	0.010 mm	0.024 mm	0.060 mm
		条码	0.082 mm	0.082 mm	0.082 mm	0.082 mm	0.082 mm
	读取距离	70 至 1000 mm	50 至 1000 mm	32 至 47 mm	70 至 1000 mm	50 至 1000 mm	
	读取查看范围	104 mm x 65 mm (距离为 300 mm 时)	267 mm x 166 mm (距离为 300 mm 时)	12.3 mm x 4.7 mm (距离为 47 mm 时)	74 mm x 55 mm (距离为 300 mm 时)	189 mm x 142 mm (距离为 300 mm 时)	
I/O 规格	控制输入	连接端口数量	2				
		输入类型	双向电压输入				
		最大额定值	30 V DC				
		最小 ON 电压	15 V DC				
		最大 OFF 电流	0.2 mA				
	控制输出	连接端口数量	3				
		输出类型	光 MOS 继电器输出				
		最大额定值	30 V DC				
		最大负载电流	1 个输出：50 mA 或更低 共计 3 个输出：100 mA 或更低				
		关机泄漏电流	0.1 mA 或更低				
以太网	开机残余电压	1 V 或更低					
	通讯标准	IEEE 802.3 兼容 100BASE-TX					
	支持的协议	TCP/IP、SNTP、FTP、SFTP、HTTP、HTTPS、BOOTP、EtherNet/IP™、PROFINET、KV STUDIO、MC 协议、OMRON PLC 链接					
	通讯标准	符合 RS-232C					
	通讯速率	600、1200、2400、4800、9600、19200、38400、57600、115200 bps					
串行通讯	支持的协议	无协议、KV STUDIO、MC 协议、SYSWAY					
	通讯标准	符合 USB 2.0 High Speed					
环境耐受性	外壳防护等级	IP65 / IP67 (IEC60529)※2					
	环境温度 / 环境存储温度	0 至 + 45°C / - 10 至 + 50°C					
	相对湿度 / 环境存储湿度	最大 85%RH (无结露)					
额定值	电源电压	24 V DC +25%/ -20%					
	电流消耗	约 750 mA		约 650 mA			
重量	约 200 g		约 225 g		约 180 g		

※1 安装以及调整时，可自动调整对焦位置。

※2 满足防护结构条件时，请安装 USB 端口盖。系统用 ROM 重写次数：10 万次

产品保证书

KEYENCE 的产品经过严格的出厂检验。如出现故障，请与就近的 KEYENCE 办事处联系，并提供故障详细情况。

1. 保质期

保质期为一年，从产品发送到购方指定地点之日算起。

2. 保修范围

- 如果在上述保质期内出现 KEYENCE 公司造成的故障，我们将免费修理产品。但是以下情况不属于保修范围。
 - 未按操作手册、用户手册或购方与 KEYENCE 公司专门达成的技术要求中规定的条件、环境下的不正确的操作，或不正确使用造成的故障。
 - 故障不是由于产品缺陷，而是购方设备或购方软件设计造成的。
 - 由非 KEYENCE 公司人员进行的修改或修理而造成的故障。
 - 按照操作手册或用户手册正确维修或更换易损件等规定可以完全避免的故障。
 - 在产品从 KEYENCE 公司发货后，因无法预料的科学技术水平变化等因素而造成的故障。
 - 由于火灾、地震和洪水等自然灾害，或异常电压等外部因素造成的故障，我公司不负责保修。
- 保修范围只限于第 (1) 条规定的情况，KEYENCE 公司对其设备造成的购方间接损失（设备损坏、机会丧失、利润损失等）或其它损失不承担任何责任。

3. 产品适用性



KEYENCE 公司的产品是针对一般行业的通用产品而设计生产的。因此，我公司产品不得用于下列应用且不适合其使用。但是，如果购方以对自己负责的态度提前就产品的使用向我方进行了咨询并了解产品的技术规范、等级和性能，并采取必要的安全措施，则产品可以使用。在这种情况下，产品保修范围和上述相同。

- 对生命和财产有严重影响的设施，如核发电厂、机场、铁路、轮船、机动装置及医疗设备
- 公共事业如电力、气体及供水服务
- 相似条件或环境的户外使用

注意

- 未经授权，不得再现本手册的全部或部分。
- 出于改进目的，本手册内容可能会有变更，恕不另行通知。
- 我们已尽最大努力确保本手册的内容尽量完整。如有任何错误或疑问，请与手册封底所列的 KEYENCE 办事处联系。
- 无论第 (3) 条是否存在，对于任何因使用本装置造成的影响，KEYENCE 概不负责。
- 任何手册如有缺页或其它页面错误将予以更换。

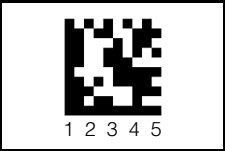
Sample Code

DataMatrix	CODE128
	
1 2 3 4 5	5 6 7 8

Software Information

■ English

Software Information

This product incorporates the software files developed independently by or for Keyence Corporation, software files owned and licensed by a third party, and software files subject to certain open source license agreements. The open source software files are subject to the notices and additional terms and conditions.

- For information about such open source software files, please refer to the information displayed on the following screen. SR Web Tool -> [Web Navigator] -> [Display reader information] -> [DISPLAY OPEN SOURCE LICENSE]
- Such open source software files are provided on an "AS IS" basis to the maximum extent permitted by applicable law. If there is any discrepancy between the terms and conditions of the applicable open source license agreement and the "License", the terms and conditions of the applicable open source license agreement prevail with respect to the applicable open source software.
- You may obtain a copy of the source code corresponding to the binaries for GPL/LGPL-licensed file by sending a request to Keyence customer service at soft-license@keyence.co.jp. There will be a charge to cover the costs of providing the source code.

■ 日本語

ソフトウェアについて

本製品は、株式会社キーエンスが独自に開発したソフトウェアコンポーネント、第三者保有で利用許諾されるソフトウェアコンポーネント、オープンソースの対象ソフトウェアコンポーネントから構成されています。

- オープンソースの対象ソフトウェアコンポーネントに関しては、SR Web Tool → [Web Navigator] → [リーダーの情報を表示する] → [オープンソースライセンスの表示]をご参照ください。
- オープンソースの対象ソフトウェアコンポーネントは、適用法令の範囲内で、“AS IS”（現状）の状態でご提供されます。
- GPL/LGPL の対象ソフトウェアコンポーネントのソースコードの入手に関しては、soft-license@keyence.co.jp へお問い合わせください。実費にてソースコードを配布いたします。

■ Deutsch

Softwareinformationen

Dieses Produkt enthält Softwaredateien, die unabhängig von oder für die Keyence Corporation entwickelt wurden, Softwaredateien, die einem Dritten gehören oder durch Dritte lizenziert sind, sowie Softwaredateien, die bestimmten Open-Source-Lizenzverträgen unterliegen.

- Die Open-Source-Softwaredateien unterliegen den Hinweisen und zusätzlichen Geschäftsbedingungen der jeweiligen Eigentümer. "Informationen zu solchen Open-Source-Softwaredateien finden Sie in den Informationen, die auf dem folgenden Bildschirm angezeigt werden. SR Web Tool -> [Web Navigator] -> [Informationen] -> [Open-Source-Lizenz anzeigen]"
- Open-Source-Softwaredateien werden in ihrer vorliegenden Form im größtmöglichen durch das anwendbare Recht gestatteten Umfang bereitgestellt. Sollten Diskrepanzen zwischen den Geschäftsbedingungen der geltenden Open-Source-Lizenzverträge und der „Lizenz“ auftreten, haben die Geschäftsbedingungen des geltenden Open-Source-Lizenzvertrags im Hinblick auf die entsprechende Open-Source-Software Vorrang.
- Sie können eine Kopie des Quellcodes der entsprechenden Binärdateien für die durch GPL/LGPL lizenzierte Datei anfordern. Senden Sie dazu eine Anfrage an den Keyence-Kundendienst (soft-license@keyence.co.jp). Für die Bereitstellung des Quellcodes werden Ihnen Kosten in Rechnung gestellt.

■ 中文 (简体)

关于软件

本产品由以下部分构成，分别为由 KEYENCE CORPORATION 独立开发的软件组件、第三方持有并允许使用的软件组件、开源的对象软件组件。

- 关于开放源代码的对象软件组件，请参阅以下信息。SR Web Tool：[Web Navigator] → [显示读码器信息] → [开源许可证的标识]
- 开源对象软件组件将在适用法律的范围内，在“AS IS”（现状）的状态下提供。
- 关于 GPL/LGPL 的对象软件组件的源代码的获取，请咨询 soft-license@keyence.co.jp 。源代码将按实际费用发放。

■ 中文 (繁体)

關於軟體的說明

本產品由株式會社KEYENCE獨家開發之軟體元件、第三者持有且獲得使用授權之軟體元件、開源的對象軟體元件組成。

- 關於開源的對象軟體組件，請參閱 SR Web Tool → [Web Navigator] → [顯示讀取器的資訊] → [顯示開源許可證]。
- 開源的對象軟體元件將於適用法律的範圍中，以“AS IS”（現狀）的狀態提供。
- 關於取得 GPL/LGPL 對象軟體元件的程式碼，請洽詢 soft-license@keyence.co.jp 我們將以成本價格發布程式碼。

■ お問い合わせ

0120-267-911

最寄りの担当営業所に直接つながります。一部のIP電話からはご利用いただけません。

■ 情報サービス

www.keyence.co.jp

カタログ、取扱説明書、マニュアル、CADデータ等をダウンロードできます。

■ 輸出書類サービス

www.keyence.co.jp/yushutsu

輸出に必要な書類をその場でダウンロードできます。

株式会社 キーエンス

自動認識事業部
〒533-8555 大阪市東淀川区東中島1-3-14

仕様は改良のため予告なく変更することがあります。記載されている会社名、製品名等は、それぞれ各社の商標または登録商標です。

自動1-1036

Copyright© 2024 KEYENCE CORPORATION. All rights reserved.

Specifications are subject to change without notice.

Copyright (c) 2024 KEYENCE CORPORATION. All rights reserved. 18202WW 2074-1 [96M18203] Printed in Japan



A69W1-MAN-2033